

Die Grinders

Die Grinders are suitable for precise, delicate finishing as required in handling small points and burrs.

■ Grip Type



RG-38CA-06
(6mm collet chuck)
RG-38CA-20
(1/4" collet chuck)



RG-382A-06
(6mm collet chuck)
RG-382A-20
(1/4" collet chuck)

■ Lever Type



RG-16AK-06
(6mm collet chuck)



RG-25-03
(3mm collet chuck)
RG-25-06
(6mm collet chuck)
RG-25-10
(1/8" collet chuck)
RG-25-20
(1/4" collet chuck)

■ Safety Lever Type



RG-38CX-06
(6mm collet chuck)
RG-38CX-20
(1/4" collet chuck)



RG-383-06
(6mm collet chuck)
RG-383-20
(1/4" collet chuck)

Safety Lever Type

- ① Push the lever down, and
- ② Grip it

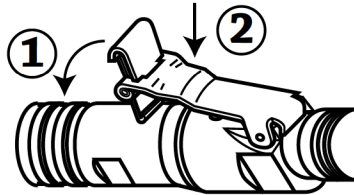

Option : Collet Bush for 3mm shank

Code No.15000720



Insert collet bush into collet chuck for 6mm to change to 3mm
Model : RG-16AK/25/38CA,CX/382A,383

Optional Collet Chuck

Model	Collet size		
	3mm	1/8"	1/4"
RG-16AK	○	○	-
RG-16AKLW	○	○	-
RG-25	○	○	-
RG-25LW	○	○	-
RG-38CA	-	-	○
RG-38CX	-	-	○
RG-382A	-	-	○
RG-383	-	-	○

Recommended air pressure 0.6MPa(6kgf/cm², 85psi)

Model	code	Capacity (Wheel size)		Collet size	Max.free speed	Overall length		Mass		Max. output		Air inlet thread	Hose size		Average air consumption	
		mm	in			mm/in	min ⁻¹	mm	in	kg	lb		kw	ps	Rc or NPT	mm
RG-38CA-06	15303	φ25	1	6mm	22000	189	7 ¹ / ₁₆	0.5	1.1	0.42	0.57	1/4	9.5	3/8	0.5	17.7
RG-38CA-20	15305	φ25	1	1/4"	22000	189	7 ¹ / ₁₆	0.5	1.1	0.42	0.57	1/4	9.5	3/8	0.5	17.7
RG-382A-06	15304	φ25	1	6mm	22000	184	7 ¹ / ₄	0.5	1.1	0.42	0.57	1/4	9.5	3/8	0.5	17.7
RG-382A-20	15306	φ25	1	1/4"	22000	184	7 ¹ / ₄	0.5	1.1	0.42	0.57	1/4	9.5	3/8	0.5	17.7
RG-16AK-06	10725	φ16	5/8	6mm	35000	178	7	0.4	0.88	0.30	0.41	1/4	6.3	1/4	0.25	8.8
RG-25-03		φ20	13/16	3mm	30000	174	6 ¹ / ₈	0.52	1.1	0.41	0.56	1/4	6.3	1/4	0.4	14.1
RG-25-06	10140	φ20	13/16	6mm	30000	174	6 ¹ / ₈	0.52	1.1	0.41	0.56	1/4	6.3	1/4	0.4	14.1
RG-25-10		φ20	13/16	1/8"	30000	174	6 ¹ / ₈	0.52	1.1	0.41	0.56	1/4	6.3	1/4	0.4	14.1
RG-25-20		φ20	13/16	1/4"	30000	174	6 ¹ / ₈	0.52	1.1	0.41	0.56	1/4	6.3	1/4	0.4	14.1
RG-16AKLW-06	10731	φ16	5/8	6mm	35000	178	6 ¹⁵ / ₁₆	0.4	0.88	0.30	0.41	1/4	6.3	1/4	0.25	8.8
RG-16AKLW-20		φ16	5/8	1/4"	35000	178	6 ¹⁵ / ₁₆	0.4	0.88	0.30	0.41	1/4	6.3	1/4	0.25	8.8
RG-25LW-03		φ20	13/16	3mm	30000	176	6 ¹⁵ / ₁₆	1.1	2.4	0.41	0.56	1/4	6.3	1/4	0.4	14.1
RG-25LW-06	10143	φ20	13/16	6mm	30000	176	6 ¹⁵ / ₁₆	1.1	2.4	0.41	0.56	1/4	6.3	1/4	0.4	14.1
RG-25LW-10		φ20	13/16	1/8"	30000	176	6 ¹⁵ / ₁₆	1.1	2.4	0.41	0.56	1/4	6.3	1/4	0.4	14.1
RG-25LW-20		φ20	13/16	1/4"	30000	176	6 ¹⁵ / ₁₆	1.1	2.4	0.41	0.56	1/4	6.3	1/4	0.4	14.1
RG-38CX-06	15180	φ25	1	6mm	22000	183	7 ³ / ₁₆	0.6	1.3	0.42	0.57	1/4	9.5	3/8	0.5	17.7
RG-38CX-20	15302	φ25	1	1/4"	22000	183	7 ³ / ₁₆	0.6	1.3	0.42	0.57	1/4	9.5	3/8	0.5	17.7
RG-383-06	15188	φ25	1	6mm	22000	178	7	0.6	1.3	0.42	0.57	1/4	9.5	3/8	0.5	17.7
RG-383-20	15300	φ25	1	1/4"	22000	178	7	0.6	1.3	0.42	0.57	1/4	9.5	3/8	0.5	17.7

Specifications are subject to change without notice.